



Catálogo de Perfis Normalizados



anicolor

Extrusão de Alumínio

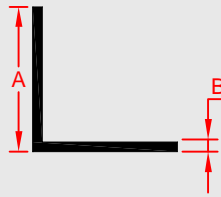
CANTONEIRAS ABAS IGUAIS

Ref.	A	B	Peso (Kg/m)
L-01	15.0	1.2	0.093
L-13	15.0	1.5	0.115
L-17	15.0	2.0	0.151
L-02	20.0	1.2	0.126
L-15	20.0	1.5	0.156
L-26	20.0	2.0	0.205
L-32	20.0	3.0	0.299
L-03	25.0	1.2	0.158
L-04	25.0	1.5	0.198
L-29	25.0	2.0	0.259
L-36	25.0	3.0	0.381
L-06	30.0	1.2	0.190
L-07	30.0	1.5	0.237
L-34	30.0	2.0	0.313
L-38	30.0	3.0	0.464

Ref.	A	B	Peso (Kg/m)
L-30	35.0	1.5	0.278
L-35	35.0	2.0	0.368
L-40	35.0	3.0	0.543
L-10	40.0	1.2	0.255
L-11	40.0	1.5	0.318
L-37	40.0	2.0	0.421
L-41	40.0	3.0	0.624
L-44	40.0	4.0	0.821
L-12	50.0	1.3	0.345
L-20	50.0	2.0	0.529
L-43	50.0	3.0	0.785
L-50	50.0	3.8	0.987
L-39	60.0	1.5	0.480
L-42	60.0	2.0	0.637
L-45	60.0	3.0	0.948
L-25	60.0	6.0	1.847

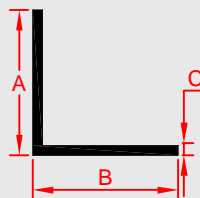
CANTONEIRAS ABAS DESIGUAIS

Ref.	A	B	C	Peso (Kg/m)
L-14	20.0	10.0	1.4	0.109
L-16	25.0	15.0	1.4	0.146
L-21	30.0	15.0	1.4	0.165
L-46	30.0	15.0	2.0	0.232
L-22	30.0	20.0	1.5	0.196
L-27	30.0	20.0	2.0	0.250
L-08	32.0	17.0	1.8	0.217
L-19	35.0	15.0	1.2	0.158

Ref.	A	B	C	Peso (Kg/m)
L-24	35.0	20.0	1.4	0.203
L-18	40.0	20.0	1.2	0.191
L-05	40.0	20.0	1.5	0.237
L-47	40.0	20.0	2.0	0.313
L-28	40.0	25.0	1.5	0.258
L-09	50.0	20.0	1.3	0.242
L-23	50.0	20.0	1.8	0.333
L-31	50.0	25.0	1.5	0.299
L-49	75.0	40.0	1.2	0.370

TUBOS QUADRADOS

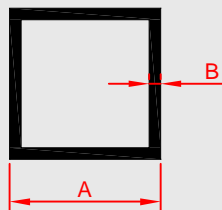

Ref.	A	B	Peso (Kg/m)	Ref.	A	B	Peso (Kg/m)
Q-10	16.0	1.0	0,162	Q-15	45.0	1.3	0.613
Q-01	19.0	1.0	0,195	Q-36	45.0	2.0	0.929
Q-29	19.0	1.5	0,284	Q-07	50.0	1.5	0.786
Q-18	20.0	1.3	0,263	Q-26	50.0	2.0	1.037
Q-35	20.0	1.5	0,300	Q-28	50.0	3.0	1.522
Q-02	20.0	2.0	0,389	Q-14	60.0	1.3	0.470
Q-25	25.0	1.2	0,308	Q-20	60.0	2.0	1.253
Q-03	25.0	1.5	0,380	Q-09	65.0	1.5	1.029
Q-30	25.0	2.0	0,497	Q-16	70.0	1.3	0.964
Q-22	30.0	1.2	0,374	Q-08	70.0	2.0	1.469
Q-04	30.0	1.5	0,462	Q-27	75.0	1.5	1.191
Q-31	30.0	2.0	0,605	Q-11	75.0	2.0	1.577
Q-24	35.0	1.2	0,438	Q-17	80.0	1.5	1.271
Q-05	35.0	1.5	0,543	Q-21	80.0	2.0	1.685
Q-32	35.0	2.0	0,713	Q-13	85.0	2.0	1.793
Q-12	40.0	1.2	0,502	Q-34	90.0	2.0	1.914
Q-06	40.0	1.5	0,624	Q-19	100.0	1.4	1.491
Q-33	40.0	2.0	0,821	Q-23	100.0	2.0	2.117

BARRAS QUADRADAS

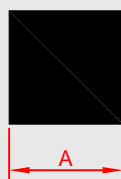

Ref.	A	Peso (Kg/m)
F-09	8.0	0.173
F-06	10.0	0.270
F-03	15.0	0.608
F-05	20.0	1.080
F-04	25.0	1.687
F-01	30.0	2.430
F-07	35.0	3.307
F-02	40.0	4.320
F-08	50.0	6.750

TUBOS REDONDOS

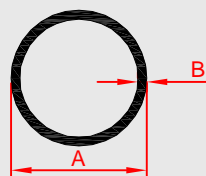

Ref.	A	B	Peso (Kg/m)	Ref.	A	B	Peso (Kg/m)
R-02	6.0	1.0	0.042	R-32	38.0	1.5	0.464
R-05	8.0	1.0	0.060	R-34	38.0	1.8	0.553
R-01	9.0	1.4	0.092	R-21	40.0	1.3	0.427
R-06	10.0	1.0	0.076	R-09	40.0	1.7	0.552
R-40	15.0	1.5	0.172	R-19	45.0	1.2	0.445
R-03	16.0	1.0	0.127	R-29	45.0	1.5	0.553
R-47	16.0	1,5	0.185	R-22	45.0	1.7	0.624
R-41	17.0	2.0	0.255	R-44	45.0	2.5	0.901
R-12	18.0	1.2	0.171	R-23	50.0	1.3	0.537
R-04	19.0	1.2	0.183	R-10	50.0	1.7	0.697
R-42	19.0	1.5	0.222	R-35	50.0	2.0	0.814
R-16	20.0	1.3	0.205	R-45	50.0	5.0	1.909
R-30	20.0	2.0	0.305	R-24	60.0	1.3	0.648
R-13	22.0	1.5	0.261	R-11	60.0	1.9	0.937
R-07	23.0	1.5	0.275	R-25	70.0	1.5	0.872
R-17	25.0	1.5	0.300	R-37	70.0	2.0	1.154
R-31	25.0	2.0	0.390	R-36	75.0	1.7	1.057
R-18	30.0	1.2	0.294	R-46	75.0	2.0	1.244
R-08	30.0	1.5	0.363	R-26	80.0	1.5	0.999
R-33	30.0	2.0	0.475	R-38	85.0	2.0	1.408
R-43	32.0	1.5	0.389	R-27	90.0	2.0	1.493
R-20	35.0	1.5	0.426	R-39	95.0	2.0	1.578
				R-28	100.0	2.0	1.663

BARRAS REDONDAS

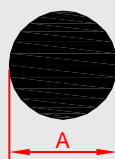

Ref.	A	Peso (Kg/m)
G-03	6.0	0.076
G-01	8.0	0.136
G-12	9.0	0.172
G-04	10.0	0.212
G-15	12.0	0.305
G-11	13.0	0.358
G-02	14.0	0.416
G-08	16.0	0.543
G-07	19.0	0.765
G-13	20.0	0.848
G-10	22.0	1.026
G-14	25.0	1.325
G-05	28.0	1.663
G-09	45.0	4.294
G-06	60.0	7.634

TUBOS RETANGULARES

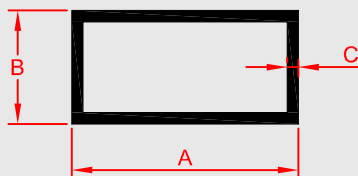

Ref.	A	B	C	Peso (Kg/m)
P-01	30.0	12.5	1.5	0.320
P-27	30.0	15.0	1.2	0.276
P-02	30.0	15.0	1.5	0.340
P-11	30.0	20.0	1.3	0.332
P-04	40.0	20.0	1.3	0.374
P-03	40.0	20.0	2.0	0.605
P-19	50.0	25.0	1.3	0.508
P-06	50.0	30.0	1.5	0.624
P-46	50.0	30.0	2.0	0.821
P-42	50.0	34.0	1.5	0.657
P-07	50.0	34.0	2.0	0.864
P-18	60.0	15.0	1.3	0.507
P-08	60.0	20.0	1.3	0.543
P-44	60.0	30.0	1.5	0.705
P-05	60.0	40.0	1.2	0.632
P-20	60.0	40.0	1.5	0.786
P-09	65.0	30.0	1.5	0.745
P-36	65.0	30.0	2.0	0.983
P-12	70.0	20.0	1.3	0.614
P-41	70.0	35.0	1.5	0.827
P-22	70.0	40.0	2.0	1.144
P-10	75.0	40.0	1.5	0.848

Ref.	A	B	C	Peso (Kg/m)
P-39	75.0	40.0	2.0	1.199
P-26	80.0	20.0	1.2	0.632
P-21	80.0	20.0	1.5	0.786
P-23	80.0	30.0	1.5	0.867
P-29	80.0	40.0	1.3	0.824
P-24	80.0	40.0	2.0	1.254
P-34	80.0	50.0	3.0	2.000
P-13	85.0	30.0	1.8	1.083
P-25	100.0	18.0	2.0	1.231
P-32	100.0	40.0	1.4	1.037
P-28	100.0	40.0	2.0	1.469
P-33	100.0	45.0	1.4	1.075
P-15	100.0	45.0	2.0	1.523
P-43	100.0	45.0	2.5	1.890
P-38	100.0	50.0	2.0	1.577
P-31	100.0	60.0	2.0	1.685
P-30	120.0	40.0	1.7	1.438
P-37	120.0	40.0	2.5	2.093
P-17	150.0	25.0	2.0	1.847
P-45	150.0	25.0	2.4	2.206
P-40	150.0	50.0	1.8	1.909
P-47	150.0	60.0	2.1	2.334
P-35	150.0	65.0	2.0	2.279

Arestas r=2mm

TUBOS RETANGULARES COM PAREDE AO CENTRO

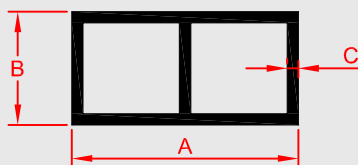

Ref.	A	B	C	Peso (Kg/m)
P-14	100.0	20.0	1.3	0.886
P-16	125.0	15.0	1.8	1.326

BARRAS RETANGULARES

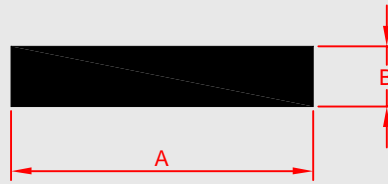

Ref.	A	B	Peso (Kg/m)	Ref.	A	B	Peso (Kg/m)
B-23	10.0	3.0	0.081	B-22	40.0	5.0	0.540
B-44	15.0	3.0	0.122	B-43	40.0	6.0	0.648
B-49	15.0	5.0	0.203	B-35	40.0	8.0	0.864
B-07	20.0	2.0	0.108	B-29	40.0	10.0	1.080
B-48	20.0	2.5	0.135	B-42	40.0	12.0	1.296
B-04	20.0	3.0	0.162	B-33	40.0	20.0	2.160
B-05	20.0	4.0	0.216	B-02	45.0	3.0	0.365
B-14	20.0	5.0	0.271	B-03	50.0	2.0	0.270
B-46	20.0	8.0	0.432	B-19	50.0	3.0	0.405
B-18	20.0	10.0	0.540	B-20	50.0	4.0	0.540
B-08	25.0	2.0	0.135	B-21	50.0	5.0	0.675
B-47	25.0	2.5	0.169	B-39	50.0	6.0	0.810
B-06	25.0	3.0	0.204	B-24	50.0	8.0	1.080
B-11	25.0	4.0	0.270	B-40	50.0	10.0	1.350
B-12	25.0	5.0	0.338	B-26	52.0	20.0	2.818
B-45	25.0	10.0	0.675	B-36	60.0	8.0	1.296
B-01	30.0	2.0	0.162	B-32	60.0	10.0	1.620
B-09	30.0	3.0	0.244	B-50	60.0	30.0	4.850
B-13	30.0	4.0	0.324	B-28	75.0	10.0	2.025
B-15	30.0	5.0	0.405	B-34	80.0	10.0	2.160
B-37	30.0	10.0	0.810	B-41	100.0	8.0	2.160
B-16	40.0	2.0	0.216	B-38	100.0	10.0	2.700
B-17	40.0	3.0	0.324	B-31	120.0	10.0	3.240
B-10	40.0	4.0	0.434	B-25	150.0	15.0	6.075

Arestas r=2mm

CALHAS U

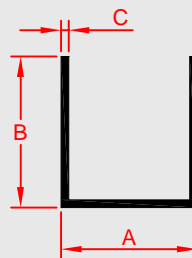

Ref.	A	B	C	Peso (Kg/m)
U-04	11.0	11.0	1.3	0.107
U-08	14.0	45.0	3.0	0.794
U-12	15.0	15.0	1.5	0.170
U-02	18.0	18.0	1.0	0.141
U-06	18.0	18.0	2.0	0.270
U-03	18.0	20.0	1.0	0.152
U-05	20.0	20.0	1.1	0.172
U-01	20.0	20.0	1.5	0.231
U-07	20.0	40.0	1.8	0.363
U-11	25.0	25.0	2.0	0.384

PERFIS EM T

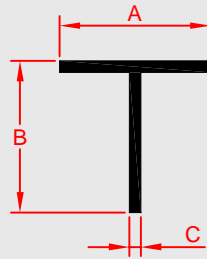

Ref.	A	B	C	Peso (Kg/m)
T-08	14.5	24.0	3.5	0.331
T-01	20.0	20.0	1.5	0.157
T-02	25.0	25.0	1.5	0.196
T-03	25.0	25.0	2.0	0.260
T-09	25.0	42.0	2.0	0.351
T-06	30.0	30.0	1.4	0.221
T-04	30.0	30.0	2.0	0.314
T-07	40.0	40.0	1.3	0.275
T-05	40.0	40.0	2.0	0.423

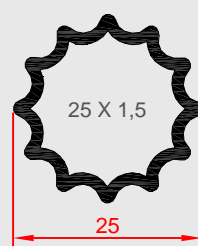

R-14

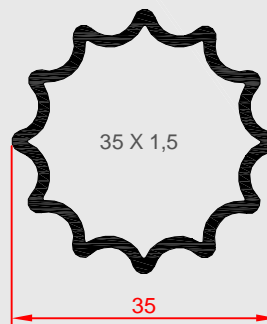

R-15



Zona Industrial de Oiã, Apt. 6
3770-908 Oiã
Oliveira do Bairro
Portugal

☎ (+351) 234 729 420

📠 (+351) 234 729 429

🌐 <http://www.anicolor.pt>

✉ extrusao@anicolor.pt